

JBC

www.jbctools.com

INSTRUCTION MANUAL



BT-2BQA

Soldering Station

This manual corresponds to the following references:

BT-2BQA (230V)

Packing List

The following items are included:



Control Unit 1 unit

General Purpose Handle 1 unit
Ref. T245-A



Power Cord 1 unit
Ref. 0023714 (230V)



Brass Wool 1 unit
Ref. CL6210

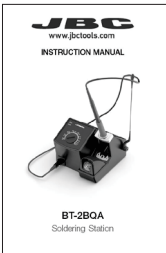

Manual 1 unit
Ref. 0030004

Features

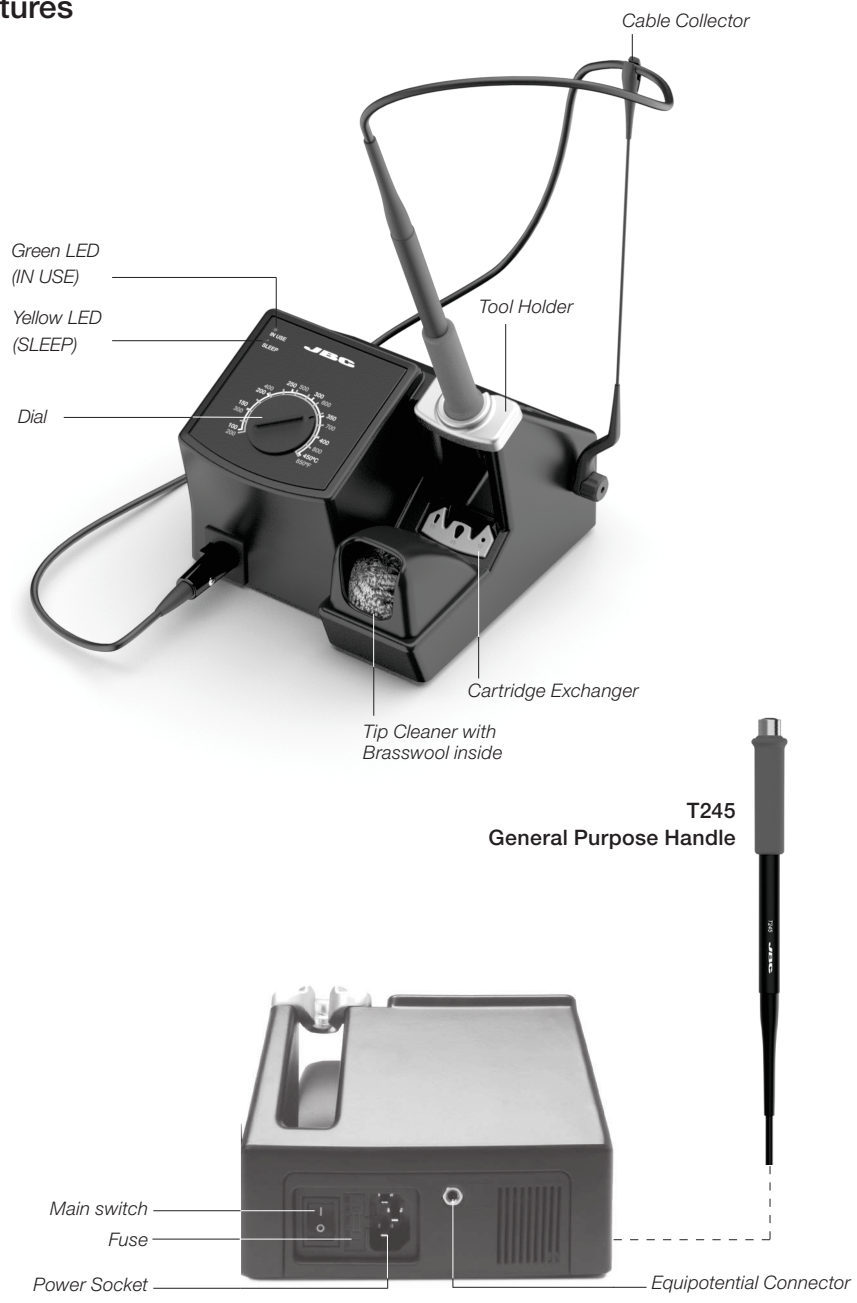

Changing Grips*

Replace the soft foam grips easily using slip-on tabs. **Note:** Choose the correct grip depending on your handle model.

Handles	Green grips	Blue grips	Black grips
T210, T210P, T210N	T8658	T3310	T3311
T245, T245G, T245P	T6057	T1528	T1530

1. Inserting Tabs

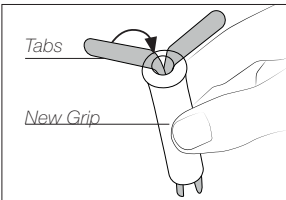

Put the slide-on tabs into the new grip.

2. Inserting Handle

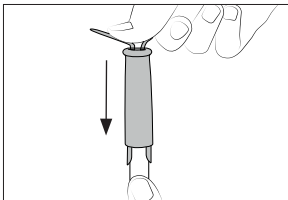

Push the grip with the tabs onto the handle.

3. Removing Tabs

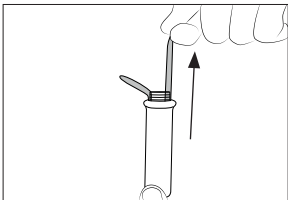

Hold the grip and pull the tab. Use pliers if necessary.

Replacing Sealing Plugs

The sealing plug prevents undesirable flux vapors or particles from entering the tool. Its usage is highly recommended for intensive applications when soldering is exposed to FOD environments or for applications where the soldering iron works close to a vertical position.

Note: Choose the correct sealing plug depending on your handle model.

Handles	Sealing Plug
T210	OB1000
T245, T470	OB2000

⚠ Before replacing the sealing plug, unplug the power supply and make sure the device is not hot.

1. Removing Sealing Plug

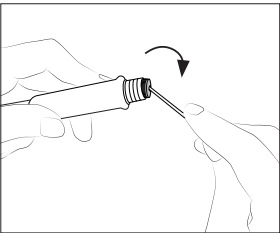

Enter a small shaft or screwdriver, not deeper than 8mm, and lift and pull the sealing plug. Never use a cartridge to do this operation.

2. Mounting Position

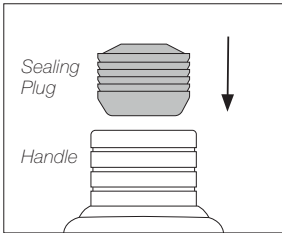

Note: The chamfered side has to be positioned towards the handle.

3. Inserting Sealing Plug

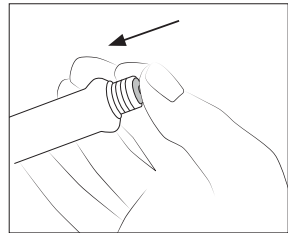

Push the sealing plug inside the handle until the sealing plug and handle edges are aligned.

** not included, sold separately*

Quick Tip Changer

Save time and change cartridges safely without switching the station off.

1. Removing

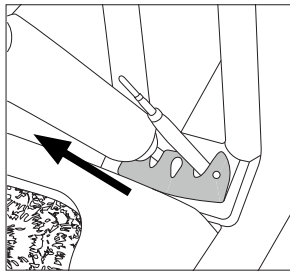

Place the handpiece in the extractor and pull it to remove the cartridge.

2. Inserting

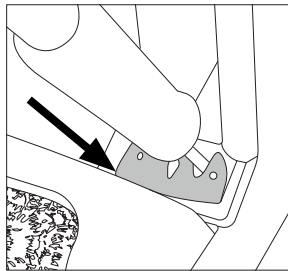

Place the handpiece on top of the new cartridge and press down slightly.

3. Fixing

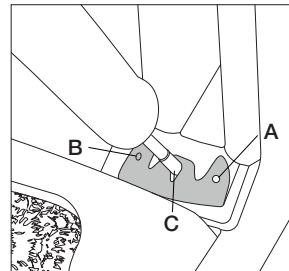

Use the holes for fixing the cartridge* as follows:

- A.** For straight C210.
- B.** For curved C210.
- C.** For C245.

*Important

It is essential to insert the cartridges as far as the mark for a proper connection.



Compatible cartridges

The BT stations work with C245 cartridges and T245/T470 handpieces or C210 cartridges with T210 handpieces. Find the model that best suits your soldering needs at www.jbctools.com

Operation

The LEDs indicate the station's different working modes.

1. Station without a tool connected: The green IN USE light flashes with the sequence (- - - - -).

2. Tool out of the support: The green IN USE light is permanently lit, indicating that the soldering iron tip is at working temperature.

3. Tool in the support (sleep mode): The yellow SLEEP light is permanently lit. In order that the tool goes into sleep mode, the tool must be in its support and the programmed sleep temperature must be less than the temp. on the dial or the prefixed temperature.

4. Station with previously fixed temperature.

(Only for users of the AC console).

Soldering iron out of support:

- If the dial is above the prefixed temperature, the green IN USE light is lit the majority of the time, switching off briefly at regular intervals (- - - - -).
- If the dial is below the prefixed temperature, the green IN USE light is off the majority of the time, lighting up briefly at regular intervals (- - - - -).
- If the dial is at the prefixed temperature, the green light is permanently lit.

Errors

When the handpiece or the cartridge is in an open circuit, the green IN USE light flashes with the sequence (- - - - -).

When the handpiece or the cartridge is in a short circuit, the green IN USE light flashes with the sequence (- - - - -).

If any of the above-mentioned causes are corrected, the station will start working automatically.

If the station is used continually in an overloaded condition for a period of time, the system will stop and both LEDs will flash simultaneously. Switch the station off and on to reset and review the soldering application.



AC Console



The original parameters of the control unit can be modified using the **AC** console.

It is necessary to connect the console AC with software revision 7.0 or later to the BT in order to configure it (consult JBC for console software updates).

Previous versions only allow for the reading of counters and do not allow for modification of parameters.

Configuration possible:

- Fixing the working temperature.
- Selection of temperature units °C or °F.
- Modification of sleep temperatures and standby times.
- Adjustment of temperature.
- Reset the parameters back to factory settings.
- Read-out data:
 - Working hours.
 - Sleep cycles and sleep hours.
 - Cartridge and iron changes.
 - Program version.

Maintenance

Before carrying out maintenance, always allow the equipment to cool.

- Clean the station screen with a glass cleaner or a damp cloth.
- Use a damp cloth to clean the casing and the tool. Alcohol can only be used to clean the metal parts.
- Periodically check that the metal parts of the tool and stand are clean so that the station can detect the tool's status.
- Maintain the tip surface clean and tinned prior to storage in order to avoid tip oxidation. Rusty and dirty surfaces reduce heat transfer to the solder joint.
- Periodically check all cables and tubes.
- Replace a blown fuse as follows:

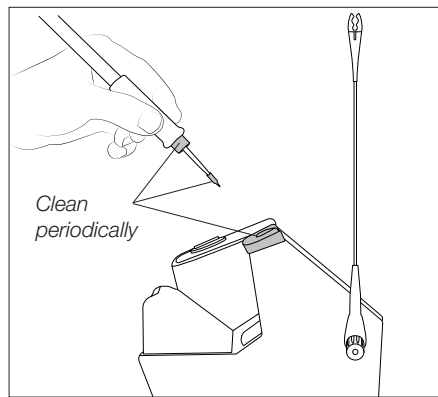

1. Pull off the fuse holder and remove the fuse. If necessary use a tool to lever it off.

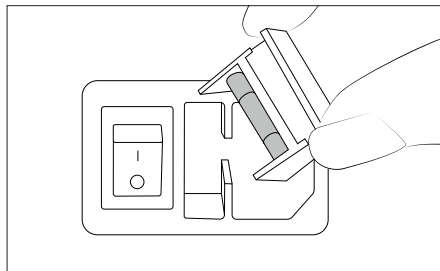

2. Press the new fuse into the fuse holder and replace it in the station.

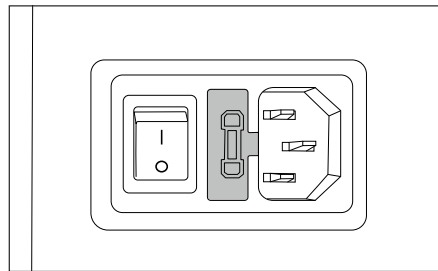

- Replace any defective or damaged pieces. Use original JBC spare parts only.
- Repairs should only be performed by a JBC authorized technical service.

Safety



It is imperative to follow safety guidelines to prevent electric shock, injury, fire or explosion.

- Do not use the units for any purpose other than soldering or rework. Incorrect use may cause a fire.
- The power cord must be plugged into approved bases. Be sure that it is properly grounded before use. When unplugging it, hold the plug, not the wire.
- Do not work on electrically live parts.
- The tool should be placed in the stand when not in use in order to activate the sleep mode. The soldering tip, the metal part of the tool and the stand may still be hot even when the station is turned off. Handle with care, including when adjusting the stand position.
- Do not leave the appliance unattended when it is on.
- Do not cover the ventilation grills. Heat can cause inflammable products to ignite.
- Use a “non-residue” classified flux and avoid contact with skin or eyes to prevent irritation.
- Be careful with the fumes produced when soldering.
- Keep your workplace clean and tidy. Wear appropriate protection glasses and gloves when working to avoid personal harm.
- Utmost care must be taken with liquid tin waste which can cause burns.
- This appliance can be used by children over the age of eight and also persons with reduced physical, sensory or mental capabilities or lack of experience provided that they have been given adequate supervision or instruction concerning use of the appliance and understand the hazards involved. Children must not play with the appliance.
- Maintenance must not be carried out by children unless supervised.



www.jbctools.com

Notes

This image shows a full page of blank, lined paper. It features approximately 20 evenly spaced horizontal grey lines across its entire width, providing a guide for handwriting or typing. The paper itself is a clean, off-white color.

This image shows a single sheet of white paper with horizontal ruling lines. The lines are evenly spaced and run across the width of the page. There are no margins, text, or other markings on the paper.

Specifications

BT-2BQA

Soldering Station

Ref. **BT-2BQA** 230V 50/60Hz. Input fuse: 1A. Output: 24V

- Power: 75W
- Temperature range: 100-450°C / 200-850 °F (±5%)
- Total Net Weight: 2.67 Kg / 5.87 lb
- Package Dimensions/Weight:
(L x W x H) 213 x 220 x 160 mm / 2.96 kg
8.39 x 8.66 x 6.30 in / 6.53 lb

Complies with CE standards
ESD safe



Warranty

JBC's 2 year warranty covers this equipment against all manufacturing defects, including the replacement of defective parts and labour.

Warranty does not cover product wear or misuse.

In order for the warranty to be valid, equipment must be returned, postage paid, to the dealer where it was purchased.

Get 1 extra year JBC warranty by registering here:
<https://www.jbctools.com/productregistration/>
within 30 days of purchase.



This product should not be thrown in the garbage.

In accordance with the European directive 2012/19/EU, electronic equipment at the end of its life must be collected and returned to an authorized recycling facility.



www.jbctools.com

0030004-070223